

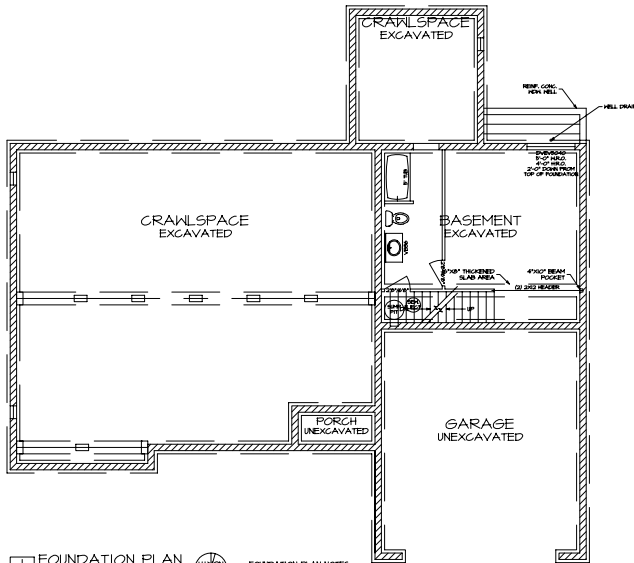

NORTH ELEVATION



FOUNDATION PLAN
SCALE: 1/4"=1'-0"



FOUNDATION PLAN NOTES:
 1. ALL DIMENSIONS ARE TO FINISH WALL UNLESS NOTED OTHERWISE.
 2. ALL FOUNDATION WALLS SHALL BE 12" MIN. THICK CONCRETE.
 3. ALL FOUNDATION WALLS SHALL BE 4" MIN. THICK CONCRETE.
 4. ALL FOUNDATION WALLS SHALL BE 4" MIN. THICK CONCRETE.
 5. ALL FOUNDATION WALLS SHALL BE 4" MIN. THICK CONCRETE.
 6. ALL FOUNDATION WALLS SHALL BE 4" MIN. THICK CONCRETE.
 7. ALL FOUNDATION WALLS SHALL BE 4" MIN. THICK CONCRETE.
 8. ALL FOUNDATION WALLS SHALL BE 4" MIN. THICK CONCRETE.
 9. ALL FOUNDATION WALLS SHALL BE 4" MIN. THICK CONCRETE.
 10. ALL FOUNDATION WALLS SHALL BE 4" MIN. THICK CONCRETE.

STATISTICS:	
AREA:	EXISTING: PROPOSED:
FIRST FLOOR AREA:	N/A 1,859 S.F.
SECOND FLOOR AREA:	N/A N/A
TOTAL LIVING AREA:	N/A 1,859 S.F.
BASEMENT AREA:	N/A 425 S.F.
GARAGE AREA:	N/A 504 S.F.
TOTAL AREA:	N/A 2,788 S.F.

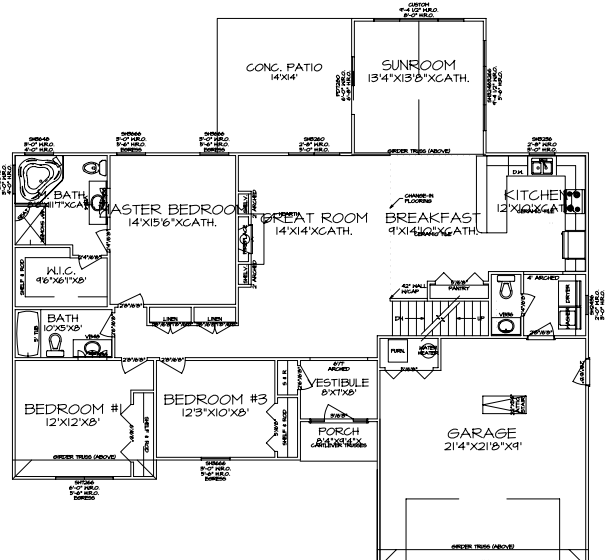

FIRST FLOOR PLAN
SCALE: 1/4"=1'-0"



FLOOR PLAN NOTES:
 1. ALL DIMENSIONS ARE TO FINISH WALL UNLESS NOTED OTHERWISE.
 2. ALL FOUNDATION WALLS SHALL BE 12" MIN. THICK CONCRETE.
 3. ALL FOUNDATION WALLS SHALL BE 4" MIN. THICK CONCRETE.
 4. ALL FOUNDATION WALLS SHALL BE 4" MIN. THICK CONCRETE.
 5. ALL FOUNDATION WALLS SHALL BE 4" MIN. THICK CONCRETE.
 6. ALL FOUNDATION WALLS SHALL BE 4" MIN. THICK CONCRETE.
 7. ALL FOUNDATION WALLS SHALL BE 4" MIN. THICK CONCRETE.
 8. ALL FOUNDATION WALLS SHALL BE 4" MIN. THICK CONCRETE.
 9. ALL FOUNDATION WALLS SHALL BE 4" MIN. THICK CONCRETE.
 10. ALL FOUNDATION WALLS SHALL BE 4" MIN. THICK CONCRETE.

GALLIVAN'S
 DRAFTING & DESIGN
 (217) 202-5998

1859SF1SB.dwg